

DCM100 SERIES DC MOTOR CONTROL

MOTOR SPEED FOLLOWS ANALOG SIGNAL
OR MANUAL ADJUSTMENT

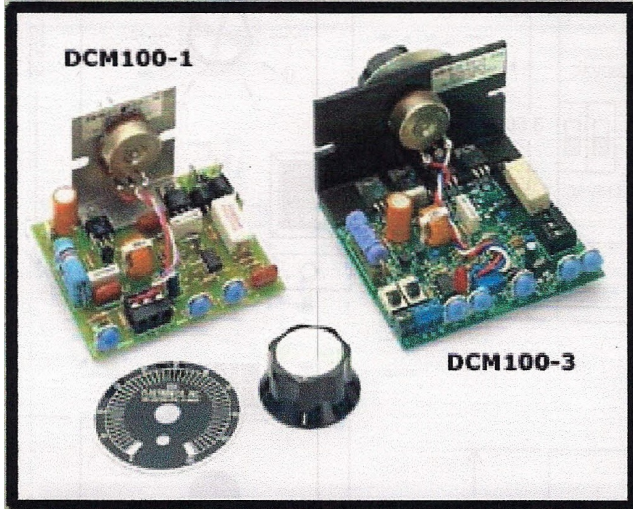

GENERAL

PURPOSE ENCLOSURE

APPLICATIONS:

- Packaging Machines
- Conveyors
- Pumps
- Machine Tools
- Index Tables
- Screening/Printing Equipment
- Wire Feeders
- Automation Equipment

FEATURES:

DCM100-1 for 1/50 through 1/2 HP

DCM100-2 for 1/2 through 1 HP

- Min, Max, IR Comp
- Soft start
- Electronic stop (S1, S2)
- Voltage following (0-10VDC) isolated signal
- Main control pot is Pre-wired to 3 position terminal block
- 120 or 240VAC 50/60 Hz
- Mounting bracket/heat sink allows for front or back panel mounting

DCM100-3 for 1/50 through 3 HP

Above Features Plus:

- Barrier blocks for all connections
- Adjustable current limit and acceleration
- 120/240VAC Switch selectable

DCM100-3SI

Signal Input Option Adds:

- Motor speed follows analog input (4-20 mA standard)
- Signal input is opto-insulated from AC line and ground
(No additional isolator boards are required)
- CAL POT for range adjustment in AUTO MODE
- Auto/Man selection (3 position terminal block for jumper or SPDT switch)

DESCRIPTION:

The **DCM100** full wave DC Motor Control is designed for excellent performance over its entire 50:1 speed range. The DCM100 can be front panel mounted using the main pot, knob and dial plate. "U" slots in the mounting bracket can be used for back panel mounting with remote pot. Either method provides additional heat sink area. Control output is a linear function of potentiometer rotation. Models DCM100- 1,2,3 can also be operated in a voltage following mode. Motor speed will follow an isolated 0 to 10VDC input signal. The DCM100-3SI output will follow a wide range of input voltage or current signals which can be specified when ordering (4-20ma is standard). The input section of this model is opto-isolated to accept non-isolated and grounded inputs. All models feature Electronic stop (S1,S2 Terminals) for repetitive ON/OFF switching of heavy armature currents with smooth acceleration each re-start. Every control is supplied with a correctly sized horsepower resistor, pre-wired main control pot and operating instructions. Enclosed models are available with line cord, switch and fuse in a heavy gauge steel enclosure. Special armature/ line voltage combinations are available. See ordering instructions.

SPECIFICATIONS

Horsepower	1/50 to 3
Load Regulation (% of Base Speed) (O to Full Load)	1%
Line Voltage Regulation (% of Base Speed, +-12% Line Variation)	.5%
Linearity (%Speed vs. Dial Rotation)	2%
Speed Range	50:1
Current Limit Range (% of Full Load)	35 to 150
Acceleration/Soft Start Time (Seconds)	.3-4.0

EDR Electronics, Inc.

1504 East Algonquin Road
Arlington Heights, IL 60005

Tel.: 847-640-6996

Fax.: 847-640-9717

www.edrelectronics.com

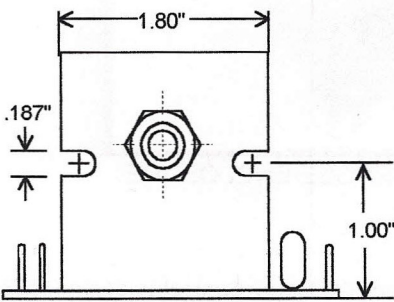
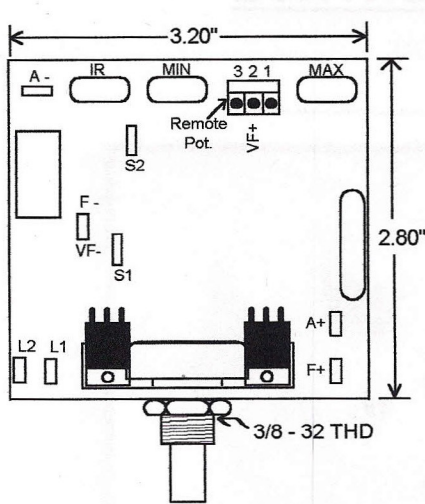

DCM100-1,2

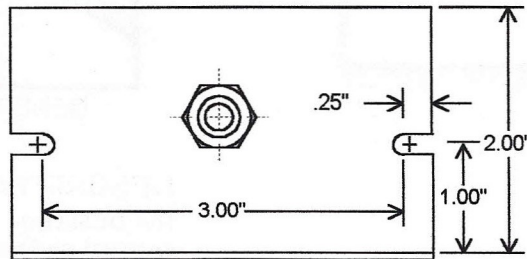
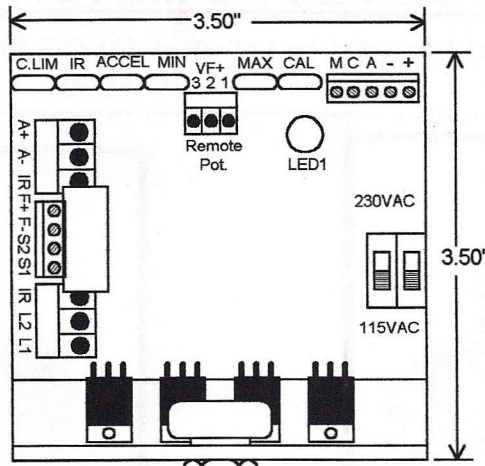

DCM100-3, 3SI

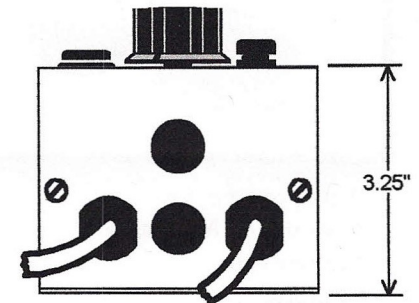
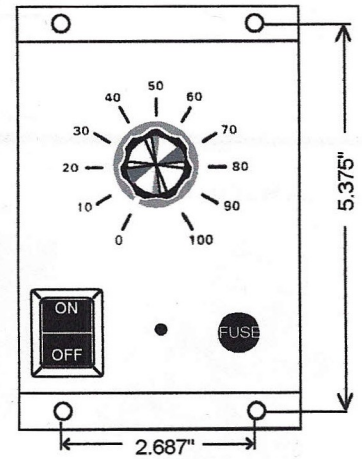

DCM100 GENERAL PURPOSE ENCLOSURE

ORDERING INFORMATION

SPECIFY DCM100- 2 1/2 HP, 90V K-D

MODEL NUMBER:

1,2,3, =Std. Control
3SI=Signal Following (1)

MOTOR SIZE:

Specify HP and Armature Voltage (2)

ACCESSORIES:

Knob=K
Dial Plate=D

ENCLOSURE:

Chasis mount=Blank
General Purpose Enclosure=ENCL
NEMA4, NEMA12, Stainless Steel=Specify

NOTES:

(1) 4-20 MA is standard (or specify range required)

(2) Correct H.P. resistor is supplied with control

Armature Voltage:

180 VDC motors require 240 VAC line 90 -130 VDC motors require 120VAC line
Special input/output voltage combinations are available (90 VDC from 240 VAC line, 12VDC from 120VAC line, etc).

EDR Electronics, Inc.
1504 E. Algonquin Road
Arlington Heights, IL 60005
847-640-6996 Fax 847-640-9717
WWW.EDRELECTRONICS.COM